

# TO LET

1,367 sq.ft (127 sq.m)

Subject to VP

15.4m  
footfall

## Phase 1 Unit 86, The Centre, Livingston, EH54 6HR

- Ground Floor retail unit
- Close proximity to ASDA
- Other nearby retailers include Greggs, Iceland, H Samuel, Primark and Poundland

Areas (approx. NIA)	Sq.ft	Sq.m
Ground Floor	1,367	127
<b>TOTAL</b>	<b>1,367</b>	<b>127</b>

### Description

The Centre Livingston offers 7,200 car parking spaces. With key fashion anchors including Flannels, River Island, Primark, JD, M&S, H&M and Schuh, The Centre is the natural choice for the fashion-conscious shopper. This offer is bolstered by other popular retailers such as Boots, Superdrug and F&B outlets including Five Guys, Wagamama, Nando's, Subway and Greggs. It benefits from circa 1,166,666 visitors a month.

### Location

Approximately 14 miles west of Edinburgh and 35 miles east of Glasgow. Livingston has key transport links to both cities by way of a central bus terminal, two train stations and connections to Scotland's central road network.









Phase 1 Site Map



Unit Floor Plan

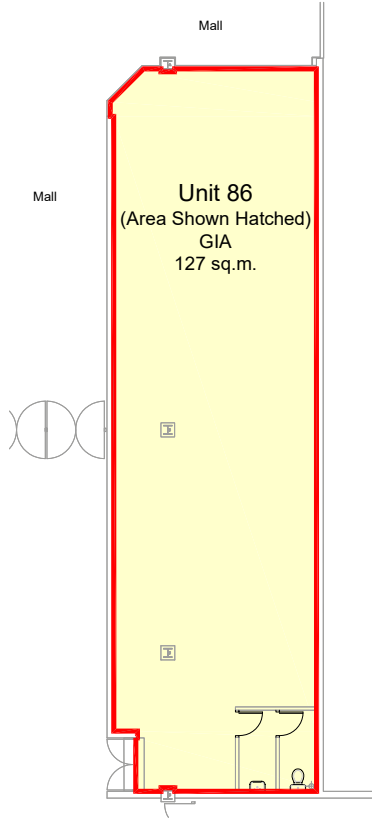

**Rent**  
£45,000 per annum.

**Rates**  
Rates Payable £20,020. Interested parties are advised to contact the local authority to confirm their liabilities and any transitional relief.

**Services**  
Electricity, water and drainage are connected to the property.

**Service Charge & Insurance**  
This unit participates in a service charge £18,548 plus VAT per annum. Insurance £880 plus VAT per annum. The Landlord will insure the premises the premiums to be recovered from the tenant.

**Viewing** Strictly via prior appointment with the appointed agents:

**Energy Performance**  
Further information available upon request.

**Planning**  
It is the ingoing tenant's responsibility to verify that their intended use is acceptable to the Local Planning Authority.

**Legal Costs**  
Each party is responsible for their own legal costs in connection with the granting of a lease.

  
savills.co.uk/retail  
**0131 247 3800**

**Stuart Moncur** 07887 795506  
Stuart.moncur@savills.com  
**Charlie Hall** 07807 999693  
Charlie.hall@savills.com

  
**0131 226 2641**  
www.eyco.co.uk

**Alastair Rowe** 07747 747280  
arowe@eyco.co.uk  
**Alexandra Campbell** 07425 335353  
acampbell@eyco.co.uk  
**Ruari Hobkirk** 07507 689 448  
rhobkirk@eyco.co.uk

Owned and Managed by

  
part of M Core  
**01384 400123**  
searchlcp.co.uk

**Rakesh Joshi** 07741 385322  
Rjoshi@lcpproperties.co.uk  
**Simon Eatough** 07771 764148  
SEatough@lcpproperties.co.uk